

ARCTIC AIR®

TURBO CHILL TOWER

INSTRUCTION MANUAL



READ ENTIRE MANUAL BEFORE USE

CONGRATULATIONS!

You're officially cooler for buying
the **Arctic Air® Turbo Chill Tower!**

If you have any questions or encounter any issues, please visit:
www.ArcticAirTurboChillTowerInfo.com
or scan the code for troubleshooting tips.

If you can't find the answer, feel free to
email our customer service team at:
AATurboChillTower@rephelpdesk.com



WHAT'S INCLUDED:

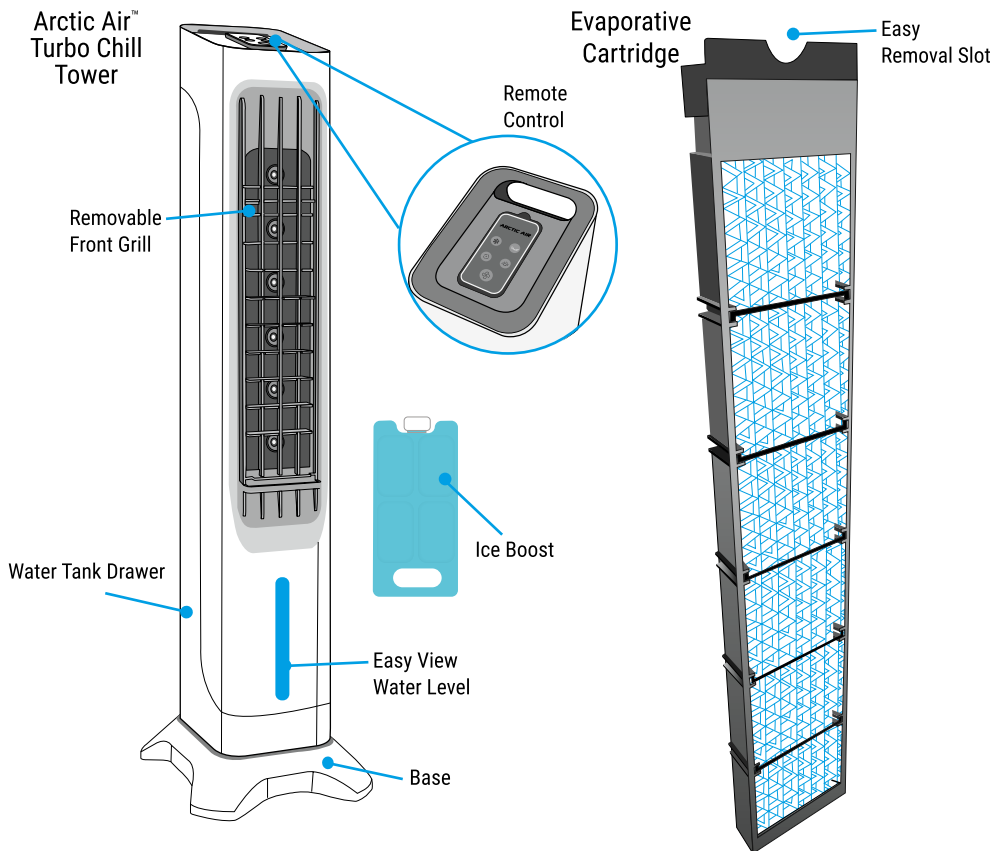

ASSEMBLY

1. Place Arctic Air® Turbo Chill Tower down so that the front grill is facing up while Base is being assembled.

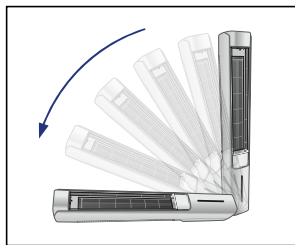

2. Assemble the two Base halves by inserting the tabs on one half into the slots on the other half.

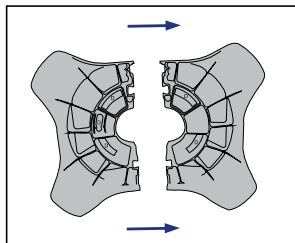

3. Align the assembled Base with the Arctic Air® Tower+. Pull the Power Cord through the hole in the center of the assembled Base.

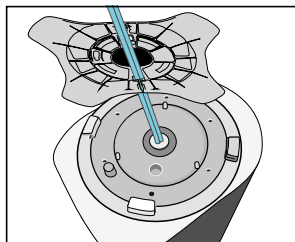

4. Insert Tower Pegs (C) into Base Slots (D) and turn the Base clockwise (towards the LOCK symbol) until it locks in place.

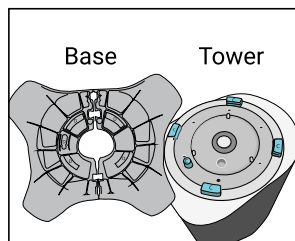

5. Pull the excess slack of the Power Cord through the hole. Plug the cord into a wall-outlet.

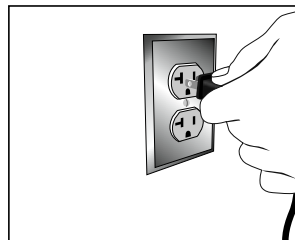

USAGE:

USING ICE BOOST:

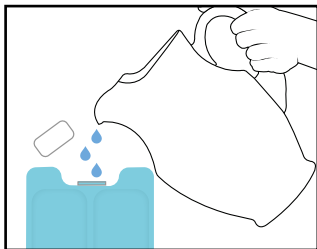

1. Unscrew top from Ice Boost and place aside. Fill with cold water and place in freezer until frozen.
2. When Ice Boost is frozen, open the drawer and slide into the slot as shown.
3. Repeat as needed when Ice Boost is no longer cold.

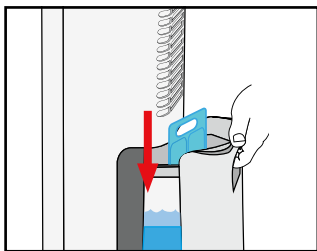

For Best Results, We recommend freezing and placing Ice Boost in water tank prior to filling to avoid overfilling and spilling. This will also help cool your water down quicker, for faster, better results.

FILLING THE TANK

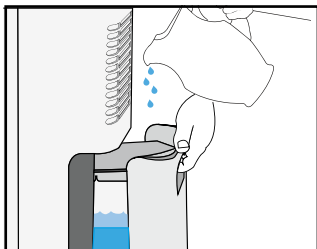

Pull out the drawer on the backside of the unit. Using a pitcher or other container, fill until MAX line. Be sure to at least fill until over MIN line or water pump will not function properly.

For Best Results, use cold water and/or ice boost.

HOW TO CHANGE BATTERY IN REMOTE

- Push in tab
- Open bracket on the right
- Release the battery

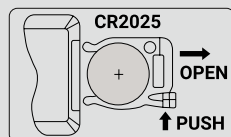

▼ RELEASE

USAGE (CONT.):

FAN SPEED

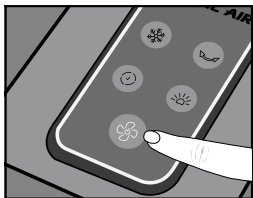

Arctic Air® Turbo Chill Tower has 3 fan speeds - Low, Medium, and High. To set desired speed, press the  button on the remote control.

COOLING CONTROL



Press the  button to activate COOLING control. You can choose HIGH cooling mode, LOW cooling mode or keep it turned off.

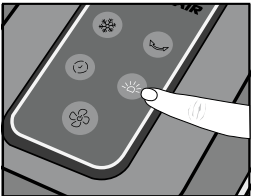

LIGHT SETTINGS

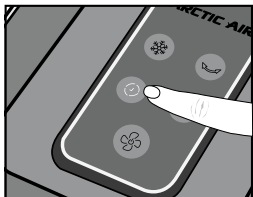

Light brightness can be adjusted to be dimmer or brighter based on your preference. Lights default to high brightness, & when  button is pressed, brightness can be adjusted to half-brightness, or off.

TIMER



You can set an auto-off timer for 2, 6, 8, or 12 hours. Simply press the  button until your duration is selected. To cancel, press  until no longer lit.

OSCILLATION



Arctic Air® Turbo Chill Tower also has wide-coverage oscillation built-in. Press the  button once for continuous oscillation, or press again to stop the unit where it is currently is.

MAINTENANCE:

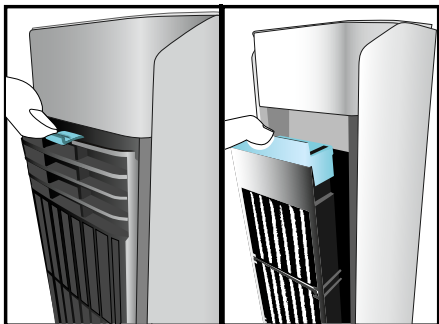

CARTRIDGE

To access, remove front grill by pressing tab on the top of the grill – place aside. Using the finger cut-out on the top of the cartridge, pull the cartridge towards you and remove.

We recommend weekly cleaning of your Arctic Air® Turbo Chill Tower and Cartridge to keep in best working condition, and replacing the Filter every 3-6 months.

Hand wash gently with warm water & soap.
Shake out excess water and let air dry.

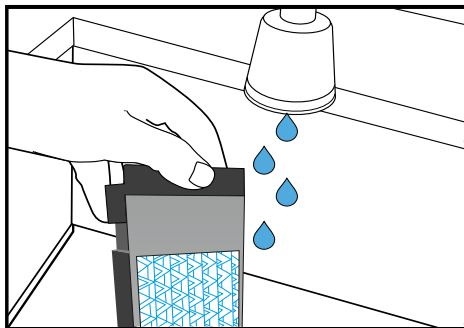

- To prepare for cleaning, run Arctic Air® Turbo Chill Tower until all water has emptied from the water tank, or hold Arctic Air® Turbo Chill Tower over a sink and carefully dump out to avoid splashing or spilling.
- If you notice water tank is dirty, use a small, bendable brush (i.e. toothbrush, bottle brush, etc) and carefully clean the inside of the tank until clean. Rinse clean with warm water.

IMPORTANT: If you see mold on the cartridge or notice a musty smell, stop and clean the filter before further use. Soak the cartridge with equal parts clean water and white vinegar – allow to sit for 45-60 minutes. Rinse with warm water, wring out and let air dry.

**To Order A New Cartridge
or Customer Service:**



Web: www.wwww.ArcticAirTurboChillTowerInfo.com



Email: AATurboChillTower@rephelpdesk.com

WARNINGS:

- Do not carry Arctic Air® Turbo Chill Tower when filled with water. Some water may remain in unit even if tank is empty.
- Use only clean water. If needed, use distilled water.
- Please read and follow regular maintenance as recommended in “Maintenance” section of this guide.
- Arctic Air® Turbo Chill Tower works best in non-polluted areas. Large dust/dirt particles may reduce lifetime of unit.
- We recommend use only in dry locations. If using in a moist area or environment, take care not to get water on external areas of the product.
- If a leak or spill occurs on the surface of device, unplug Arctic Air® Turbo Chill Tower and let it dry for 24 hours. Then, use as normal.
- Do not place in direct sunlight for extended periods of time.
- Before not using Arctic Air® Turbo Chill Tower for extended periods of time, empty the water tank, turn unit on, and set to highest fan speed for at least 4 hours. This will dry out then filter and inside of your unit.
- Only use the original power adapter and cord supplied in package.
- Do not touch the power supply or power cord with wet hands.
- Unplug Arctic Air® Turbo Chill Tower when cleaning, removing/replacing cartridge, or moving the device.
- For best results, place Arctic Air® Turbo Chill Tower on a higher surface like a table or countertop.
- Do not place Arctic Air® Turbo Chill Tower near a heater or any electrical equipment.
- Do not place the device in passageways or high traffic areas where there is a possibility of tripping or knocking it over.
- Do not allow any foreign objects inside Arctic Air® Turbo Chill Tower.
- Do not place items on top Arctic Air® Turbo Chill Tower.
- Do not block the front and back grills of the device.
- Do not turn the device upside down.
- Do not submerge the Arctic Air® Turbo Chill Tower under water or other liquids.
- Do not place Arctic Air® Turbo Chill Tower near open flames or fire sources.
- People with limited physical, visual or mental abilities or lacking proper experience and/or knowledge should never use the device without supervision of those responsible for their safety or those capable of assistance in using the device.
- The device can be switched off completely only when disconnected from the power supply.
- The manufacturer does not bear any responsibility for any damage from failure to comply with this product guide.
- A replaceable water cartridge is designed specifically for this product. If your cartridge has been broken or damaged, you can purchase a replacement.

ONTEL® ASSUMES NO RESPONSIBILITY FOR ANY INCIDENTAL OR CONSEQUENTIAL DAMAGES ARISING OUT OF YOUR USE OF THE PRODUCT. IN PURCHASING AND USING THIS PRODUCT, YOU ASSUME ALL RESPONSIBILITY FOR CLEANING THE PRODUCT AND MONITORING THE PRODUCT FOR MOLD. ADDITIONALLY, ONTEL® SPECIFICALLY DISCLAIMS ALL EXPRESSED WARRANTIES NOT OTHERWISE SET FORTH HEREIN AND ANY IMPLIED WARRANTIES OF MERCHANTABILITY OR FITNESS FOR A PARTICULAR PURPOSE. THERE ARE NO WARRANTIES WHICH EXTEND BEYOND THE DESCRIPTION OF THE FACE HEREOF.

FOR BEST RESULTS:

PRE-SOAK FILTER:

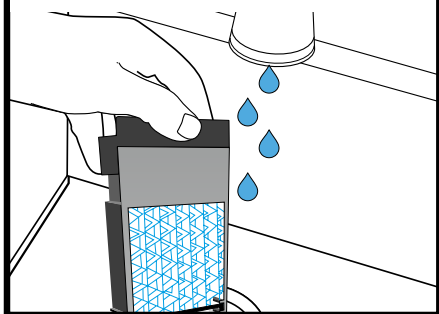

To **ACTIVATE COOLING**, soak your filter under running water.

USING COOLING CONTROL:



Fill and Freeze Ice Boost pack prior to use. Place in water tank prior to filling to avoid overfilling.

FILL WITH PITCHER:

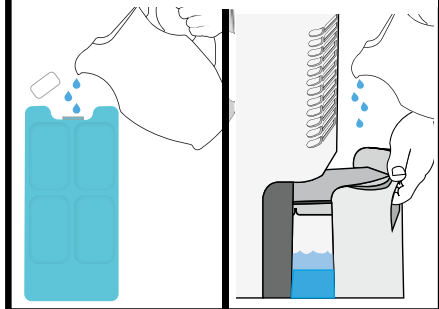

Place on flat surface & fill tank from a water pitcher.

USING ICE BOOST:

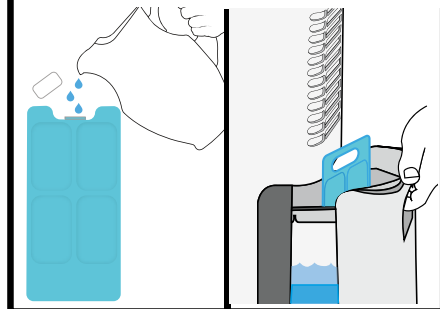

Control cooling output by pressing button. You can choose HIGH cooling mode or LOW cooling modes.

See Product Guide for Care & Cleaning instructions.

DO NOT USE ARCTIC AIR® TURBO CHILL TOWER WITHOUT CARTRIDGE. WATER MAY LEAK OUT ONTO THE FLOOR

Please Note: You may notice some condensation forming on the front grill. This is normal.

FOR HOUSEHOLD USE ONLY



©2024 Ontel Products Corp.
Fairfield, NJ 07004
All Rights Reserved.

Made In China
U.S. Pat No. 11,7745,116
Additional patents pending.
AATCT-IM-01-1124-200